

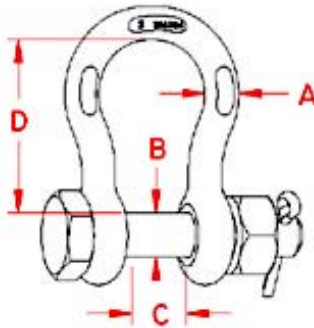

BOLT ANCHOR SHACKLE

The Bolt Anchor Shackle is made from grade 316 stainless steel and features an oversize bolt. Stainless steel anchor shackle with oversize bolt is ideal for salt water applications. The Bolt Anchor Shackle is primarily used to connect the anchor to the chain or anchor swivel.



BOLT ANCHOR SHACKLE

GRADE: 316-NM STAINLESS STEEL

I/A/W Fed Spec RR-C-271D, Type IVA, Class 3, Except 316 Stainless, Drop Forged & Load Rated

ITEM	A (size)	B	C	D	WLL (lb)	WT (lb)
S0116-SA07	1/4"	0.31"	0.47"	1.11"	1,000	0.12
S0116-SA08	5/16"	0.38"	0.53"	1.20"	1,300	0.18
S0116-SA10	3/8"	0.44"	0.66"	1.41"	1,500	0.35
S0116-SA12	7/16"	0.50"	0.72"	1.77"	2,000	0.57
S0116-SA13	1/2"	0.63"	0.82"	1.83"	3,000	0.84
S0116-SA16	5/8"	0.75"	1.02"	2.41"	4,000	1.64
S0116-SA20	3/4"	0.88"	1.25"	2.84"	6,000	2.75
S0116-SA22	7/8"	1.00"	1.48"	3.30"	8,000	4.18
S0116-SA25	1"	1.13"	1.70"	3.80"	10,000	5.61
S0116-SA32	1-1/4"	1.38"	2.03"	4.69"	14,000	9.88



Rigging
Warehouse.com

Tel 1.877.331.3280
Fax 1.845.338.1372